

- 1 MUST BE ASSEMBLED WITH CAP REAR P/N 770052-1 BEFORE MATING. KIT P/N IS 770027-1.
- 2 RECOMMENDED PANEL THICKNESS 0.76-2.29 [.030-.090].
- 3 PANEL MUST BE PUNCHED SO THAT THE HOUSING ENTERS THE PANEL IN THE SAME DIRECTION AS THE PUNCH.
- 4 OPTIONAL FOR KEYING HOUSING IN PANEL.
- 5 CIRCUIT NUMBER 1 LOCATION.
- 6 AMP LOGO LOCATED ONCE ON ANY INDICATED SURFACE FARSIDE.
- 7 DIMENSION INDICATED IS AS MOLDED. ADDITIONAL GROWTH DUE TO SUBSEQUENT MOISTURE ABSORPTION MAY OCCUR.
- 8 OPTIONAL CONSTRUCTION PROVIDES ROUND MATERIAL REDUCTION CORING HOLES.

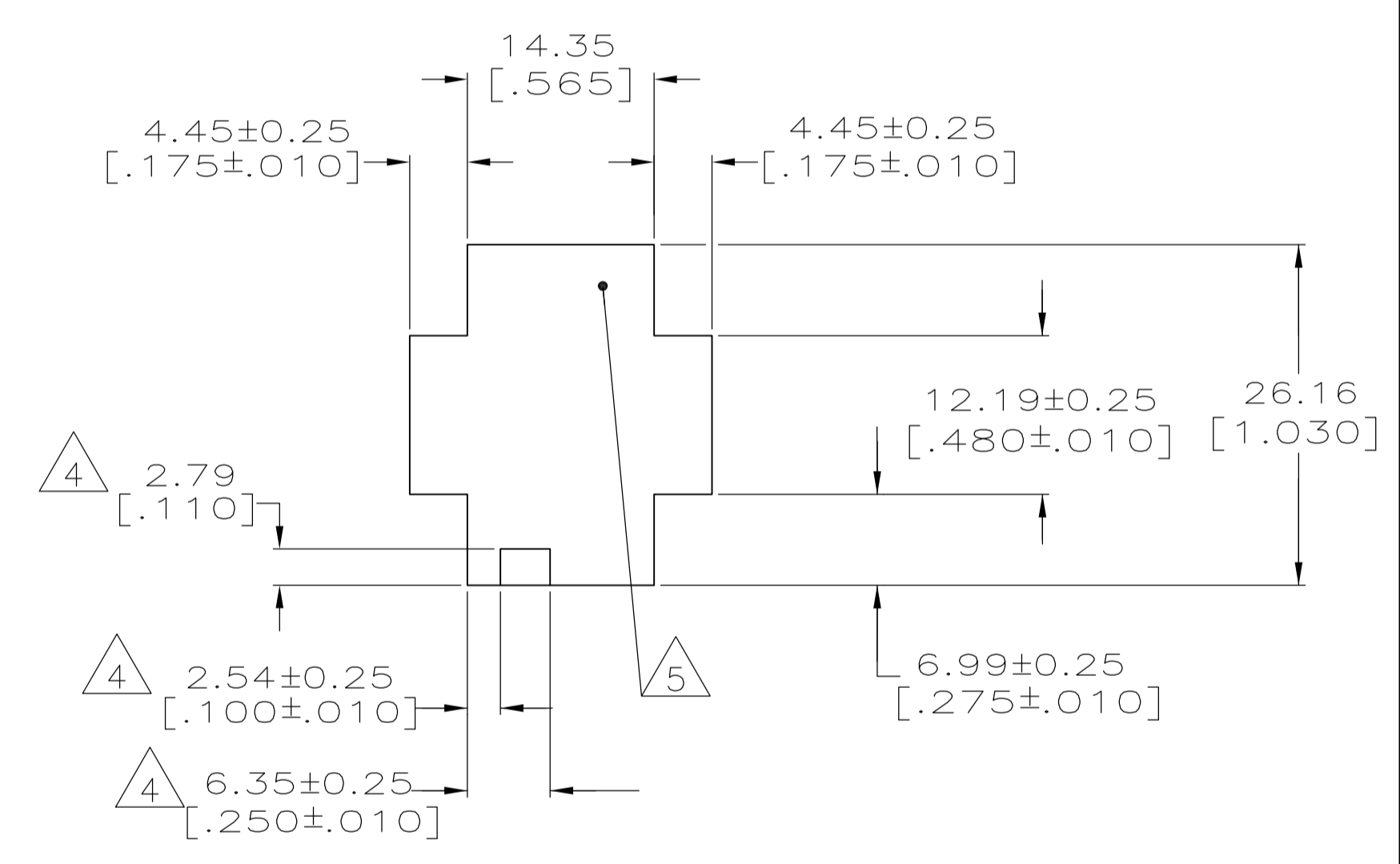
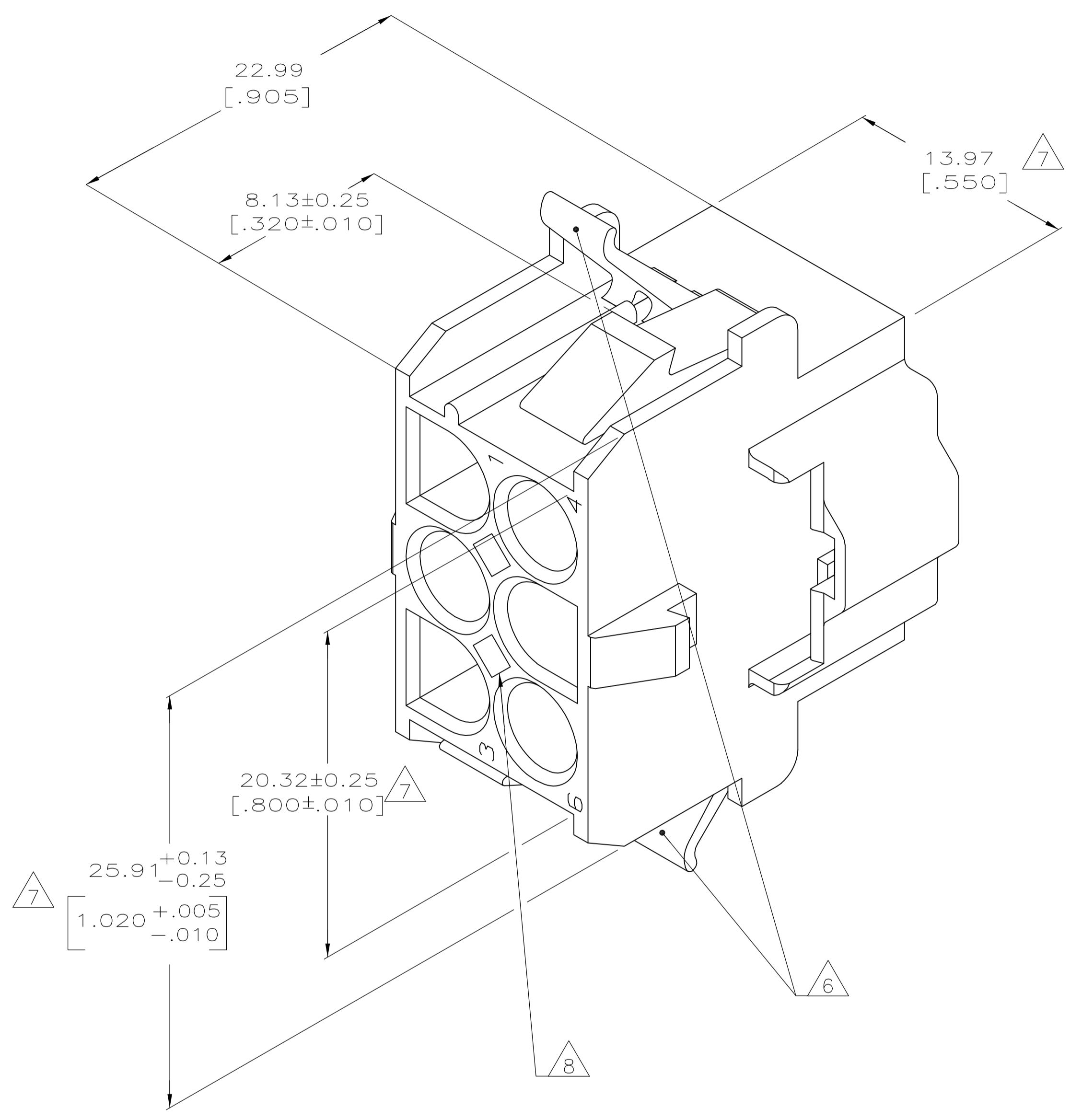

RECOMMENDED PANEL CUTOUT
(HOUSING ENTRY SIDE)
SCALE 2:1

770051-1
PART NUMBER

THIS DRAWING IS A CONTROLLED DOCUMENT.		DIN K SALMON 1-15-92	TE Connectivity	
DIMENSIONS: mm [INCHES]		CHK R SWING 1-15-92		
TOLERANCES UNLESS OTHERWISE SPECIFIED:		APVD M TRULL 1-16-92	NAME	
0 PLC ± -		PRODUCT SPEC	CAP FRONT, 6 CIRCUIT, UNIVERSAL MATE-N-LOK™II	
1 PLC ± -		APPLICATION SPEC	SIZE CAGE CODE DRAWING NO	
2 PLC ± 0.25 [.010]			A1 00779 C=770051	
3 PLC ± -			RESTRICTED TO	
4 PLC ± -			CUSTOMER DRAWING	
ANGLES ± -			SCALE 5:1 SHEET 1 OF 1 REV K	
MATERIAL NYLON,UL94V-0, FINISH -		WEIGHT -		